

CERTIFIED LAND CORNER RECORDATION

DESCRIPTION OF CORNER EVIDENCE FOUND, AND ORIGINAL RECORD (if known)

LOCATION
 Sec. Cor.
26 | 25
35 | 36
 T. 16 N., R. 62 W.
 6th P. M.

The only evidence of corner found was fence corner.

Corner restored by taking oaths from the adjacent land owners; Willis King and Hazal Woolington. Willis King has sworn to the fact that he and his father removed the stone and set the fence corner in the location from which they removed the stone.
 G.L.O. record not known.

DESCRIPTION OF MONUMENT AND ACCESSORIES ESTABLISHED TO PERPETUATE THE ORIGINAL LOCATION OF THIS CORNER:

Set a 5/8" rebar with aluminum cap at S. W. corner of fence corner.

Set wood stake and lath.

SKETCH, WITH COURSE AND DISTANCE TO ADJACENT CORNER IF DETERMINED IN THIS SURVEY.
 (May Sketch or Paste Reproduction on Reverse Side.)

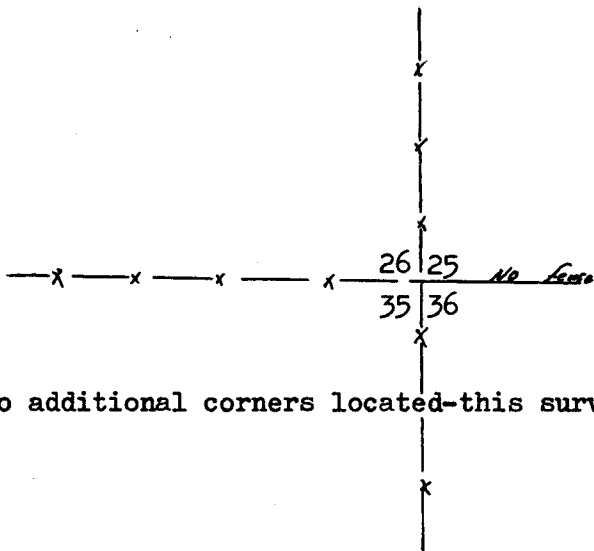

No additional corners located this survey.

I, Robert C. Corbet certify that I have carefully performed or reviewed the work done on the diagrammed corner as reported on this recordation form and approve the same.

Robert C. Corbet 495
 Signature of Surveyor Registration No.

STATE OF WYOMING,
 Office of Clerk and Recorder,
 County of Taramie

This "corner record" was filed for record on the 9 day of August, 1923, was noted on the cross-index plat and is assigned page No. _____, in book No. _____.

County Official		
Cross Index No. <u>V-21</u>	T. <u>16</u>	R. <u>62</u> <u>6</u> Mer.
_____	T. _____	R. _____ Mer.
_____	T. _____	R. _____ Mer.
_____	T. _____	R. _____ Mer.
_____	T. _____	R. _____ Mer.
_____	T. _____	R. _____ Mer.
_____	T. _____	R. _____ Mer.

Photographed ✓

Indexed *FB*

Posted ✓

Assessor ✓

The State of Wyoming }
County of Laramie } SS

This instrument was filed for record
at 1:14 o'clock P. M. on the

A. D. 19 23 day of August

Book _____ on page _____

John B. Williams

County Clerk & Ex-Officio Register of Deeds
By *FB* Deputy